

Tessa

Quick Start Guide

Web address

<https://tessapp.ai> (Use your Google account to save papers to your library)

Current coverage

Open Access, PMID & preferably randomized control trial or clinical trial.

How to Search

For the best results, start by searching with a specific:

- **PMID** (e.g., 30657532)
- **Full Article Title** (e.g., "Risks and Benefits of Estrogen Plus Progestin...")

About Your Search Settings

① "Open Access" Filter is ON by Default

To show the widest range of results, your first search will only include articles that are open access.

How to Change This: After you complete your first search, a "Filters" or "Settings" box will appear. You can uncheck "Open Access" there to see all articles, including those behind a paywall.

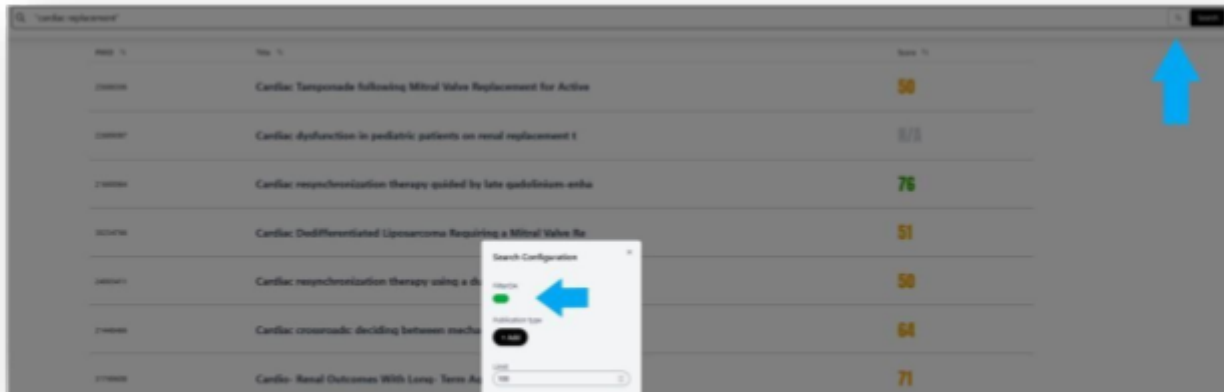

Analysis & Processing Time

When you select a paper, our system begins a deep analysis. This process can take up to **5 minutes** for complex articles.

You can track the live status (e.g., "Processing," "Downloading") in the **Analysis Section**.



Troubleshooting

If the page does not update after 5 minutes or if an error message appears, please **refresh your browser**. A simple refresh will not lose your request and will sometimes resolve the issue and display the completed analysis. You can also try Shift-Reload (or Hard Refresh) which forces your browser to bypass its stored cache and download the most recent version of the application directly from the server. This ensures you are seeing the latest updates and fixes rather than a potentially "stuck" or outdated version of the page.

Shortcut Keys

Mac / Apple	Hold Shift and click the Reload icon, or press Command (⌘) + Shift + R
Windows / PC	Hold Ctrl and press F5 (or click the Refresh icon)

Reasons for a paper not loading

If the paper fails to load, it's likely behind a paywall or has other processing limitations.

Early Access Disclaimer

The application may have bugs or other issues.

Example of a completed report

<https://tessapp.ai/report/34003663>

Submit bug or feature requests using this email address: justin@siensmetrica.com

High Level Info on Our Scores:

At the heart of the Tessa platform is its multi-vector rating system. The platform operates on the premise that a single metric, such as a journal's impact factor, is an insufficient measure of a study's true quality and trustworthiness. Instead, Tessa assesses research across multiple distinct vectors, providing a comprehensive, holistic view of its credibility. Listed below are a breakdown of the scores.

SCORE	PURPOSE	CORE QUESTION ANSWERED
Overall	A primary, weighted aggregate of all other scores.	What is the holistic trustworthiness of this research?
Methods/Quality 66.7% of overall score	Evaluates the internal validity and rigor of the research methodology.	Is the study's design and execution sound and reproducible?
Author impact (AH5*) 13.9% of overall score	Measures the credibility and publication history of the authors.	Are the authors recognized experts in their field?
Journal 14.44% of overall score	Assesses the external credibility and reputation of the publication venue.	Is this research published in a reputable and well-regarded journal?
Media 5% of overall score	Analyzes how often the paper is discussed on social media and search engines.	How popular or active is this paper's title?

*AH5 = (max author h-index-5 score/100)